

TL2650 Feedthrough Filter

Current Ratings: 100 Amps
Operating Voltage: 230VAC / 350VDC (TL2650)

This single line, high performance feed-through filter provides excellent EMI/RFI protection. Offering high attenuation. This is an economical alternative to dedicated filter units, where multiple input or output power lines require suppression.

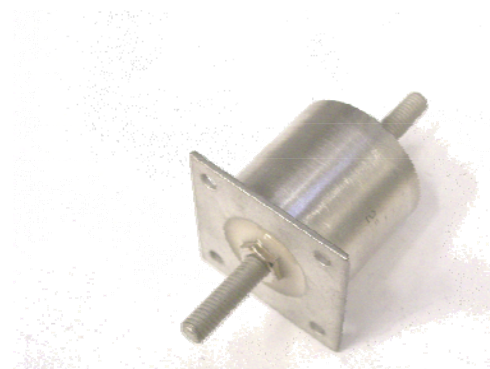

TYPICAL APPLICATIONS

- Screened rooms.
- High frequency welding equipment.
- Power supplies.
- Telecom systems.
- Medical Applications.
- Military.

TECHNICAL ADVANTAGES

- Current rating 100A.
- Excellent attenuation up-to 1GHz and above.
- Rugged resin sealed construction.
- Flange-mounting.

ELECTRICAL SPECIFICATIONS

- Rated voltage (V_R): 230VAC 50/60Hz
- Rated current (I_R): referred to 40°C
- Insertion Loss (dB.): see table
- Climatic category: GPC (40/085/56);
- Temperature range: -20°C to +70°C

MECHANICAL SPECIFICATIONS

Manufacture: brass case and stud that is tin plated; Metric stud, nut and washers (TL2650)

Connections: Metric M6 full nuts, spring washers, plain flat washers and threaded M6 bar.

Note: on screwing the cable to the filter, the lock nut must be held in position to avoid a torque to the threaded bar inside the filter.

Part no.	In (A)	VAC/VDC	Cp (μF)	Temperature Range C	Dimensions (mm)									
					A	B	C	D	E	F	G	H	I	J
TL2650	100	230/350	0.25	-20 - +70	80.00	60.50	58.50	24.50	22.90	20.9	29.20	40.00	X4 4.00 Ø	33.00 Ø

DIMENSIONS & CASE STYLES

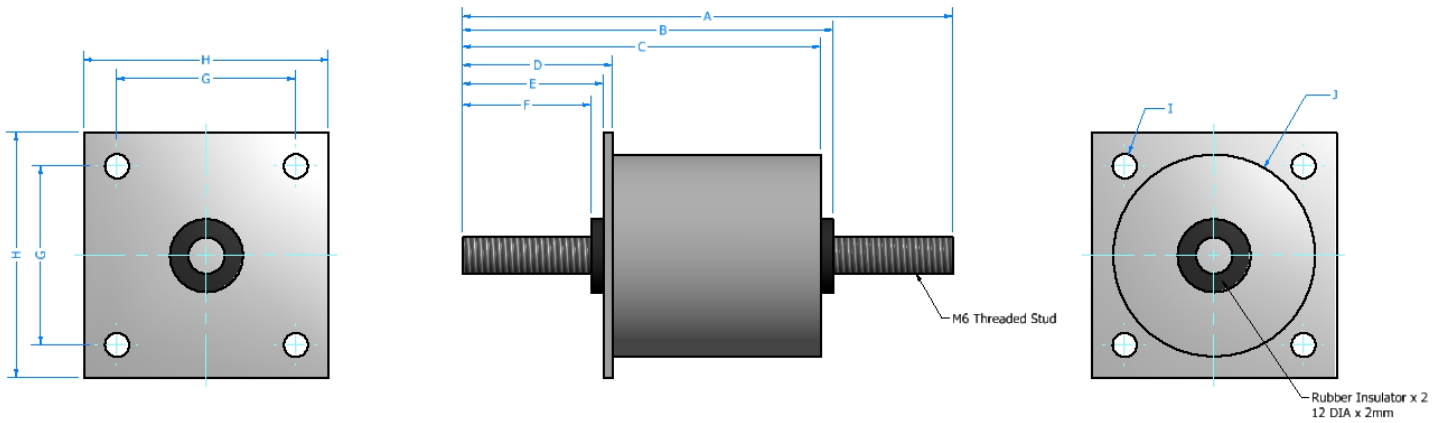

PERFORMANCE GRAPH (INSERTION LOSS)

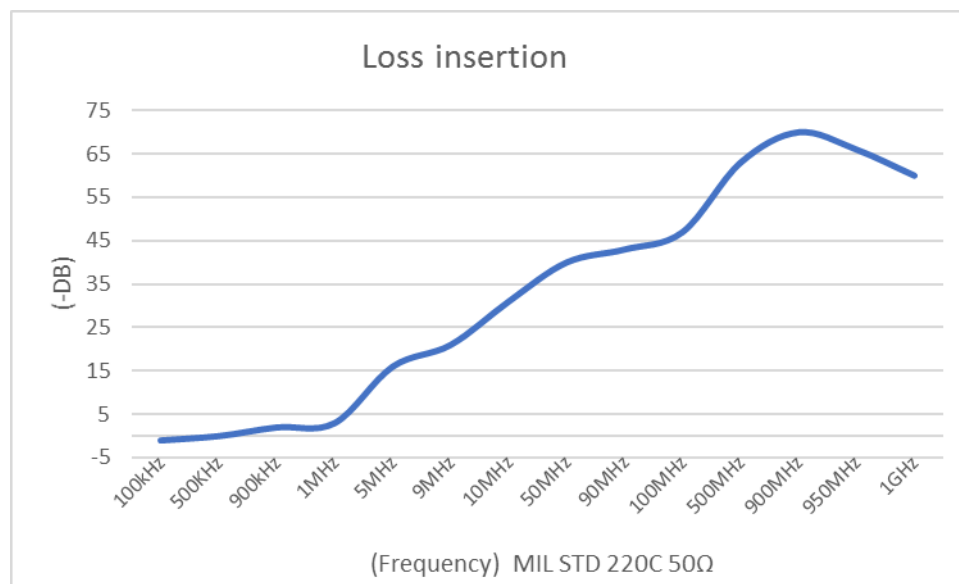

ELECTRICAL SCHEMATIC (Pi configuration)

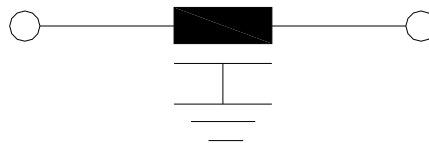

ORDERING INFORMATION

TL2650

Other sizes available on request.